



CE EN 60974-7

SPM 150

SPM 250

SPM 240

SPM 360



MIG GUN	CAPACITY X60%		WIRE DIAMETER
SPM 150	180A CO ₂	150A mixed gases	0.6 - 1.0 mm
SPM 250	230A CO ₂	200A mixed gases	0.8 - 1.2 mm
SPM 240	250A CO ₂	220A mixed gases	0.8 - 1.2 mm
SPM 360	320A CO ₂	290A mixed gases	0.8 - 1.6 mm

From many years generally well-known and highly valued by professionals SPARTUS® guns have achieved status of **SPARTUS Master**. They have been marked by new, relevant logo.

SPARTUS MIG guns are master combination of high quality, perfect parameters and ergonomic.

Characteristic-profiled handle, moving ball joint and flexible power cable-capable of moving large loads make our torches unique.

SPARTUS Master MIG guns were designed with thought of various works which require special approach to the task.

5 main advantages of SPARTUS Master MIG guns:

- ★ High quality of implementation.
- ★ Checked from many years and appreciated design of torch.
- ★ High duty cycle.
- ★ Versatility of available solutions (flexible, rotary and extended torches).
- ★ Compliance of world standard.

MIG GUNS - PARTS

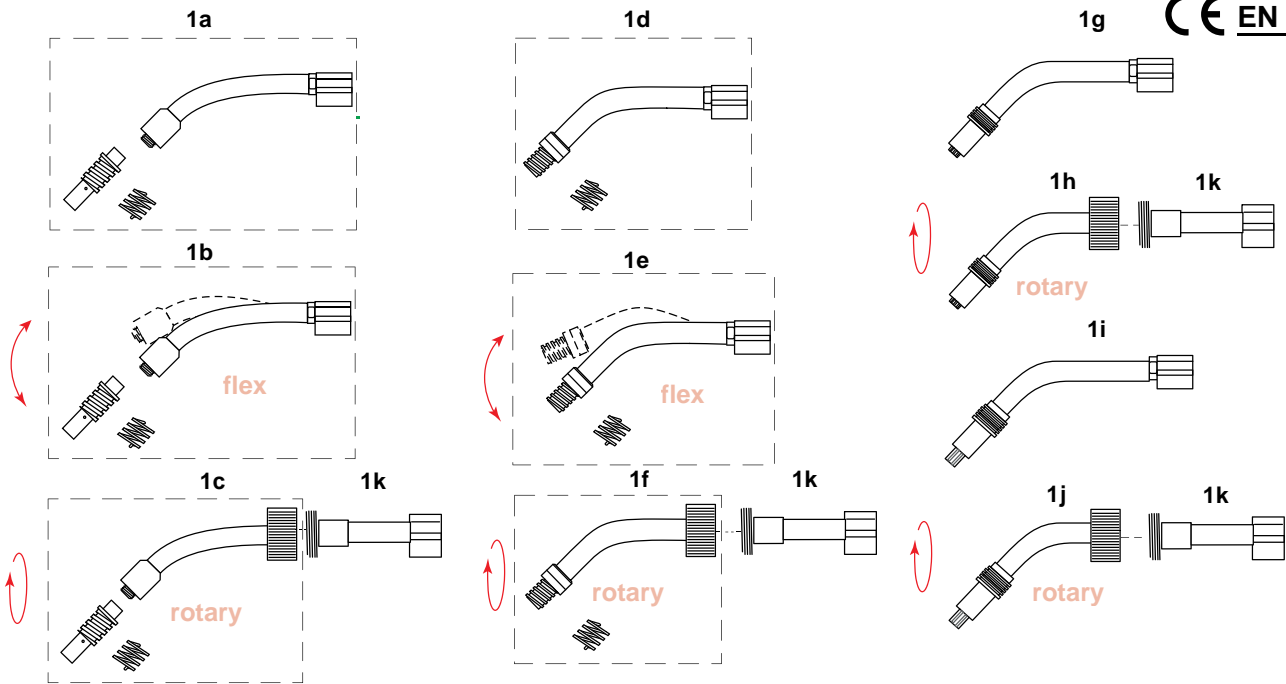

NO.	CODE	DESCRIPTION	NO.	CODE	DESCRIPTION
1a	15-00-001	Torch 150 with contact tip holder	1g	24-00-001	Torch 240
1b	15F-00-001	Flexible torch 150F with contact tip holder	1h	24R-00-001	Rotary torch 240R
1c	15R-00-001	Rotary torch 150R with contact tip holder	1i	36-00-001	Torch 360
1d	25-00-001	Torch 250 with spring	1j	36R-00-001	Rotary torch 360R
1e	25F-00-001	Flexible torch 250F with spring	1k	15R-00-002	Rotary torch adaptor
1f	25R-00-001	Rotary torch 250R with spring			

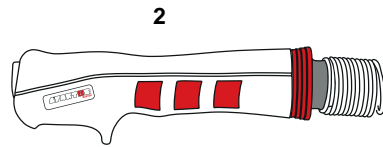

2.1

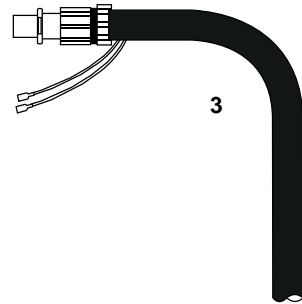

3

NO.	CODE	DESCRIPTION
2.1	15-70-001	Orange microswitch (trigger)

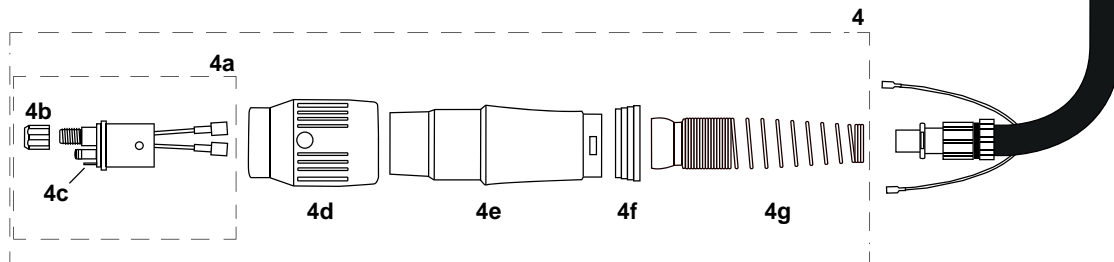

4

NO.	CODE	DESCRIPTION	SPM 150	SPM 250	SPM 240	SPM 360
2	SP15-80-001	Handle MASTER with spring (without microswitch)	•	•	•	•
3	SPM15-95-300	Current - gas hose 3m MASTER	•			
	SPM15-95-400	Current - gas hose 4m MASTER				
	SPM15-95-500	Current - gas hose 5m MASTER				
	SPM25-95-300	Current - gas hose 3m MASTER		•	•	
	SPM25-95-400	Current - gas hose 4m MASTER				
	SPM25-95-500	Current - gas hose 5m MASTER				
	SPM36-95-300	Current - gas hose 3m MASTER				•
	SPM36-95-400	Current - gas hose 4m MASTER				
	SPM36-95-500	Current - gas hose 5m MASTER				
4	15-81-00M	EURO connector plug set MASTER	•	•	•	•
4a	15-81-100	EURO connector spring pins	•	•	•	•
4b	15-81-109	Liner nut	•	•	•	•
4c	15-81-101	Spring pin	•	•	•	•
4d	15-81-108	Gun plug nut EURO MASTER (grey)	•	•	•	•
4e	15-81-102	EURO connector plug shield	•	•	•	•
4f	15-80-103	End cap	•	•	•	•
4g	15-80-104	Joint with spring EURO MASTER	•	•	•	•

MIG GUNS - COMPLETE

CODE	DESCRIPTION
SPM15-12-300	Handheld MIG gun MASTER 150 set 3m
SPM15-12-400	Handheld MIG gun MASTER 150 set 4m
SPM15-12-500	Handheld MIG gun MASTER 150 set 5m

CODE	DESCRIPTION	CODE	DESCRIPTION
SPM15F-12-300	Handheld MIG gun MASTER 150F set 3m	SPM15R-12-300	Handheld MIG gun MASTER 150R set 3m
SPM15F-12-400	Handheld MIG gun MASTER 150F set 4m	SPM15R-12-400	Handheld MIG gun MASTER 150R set 4m
SPM15F-12-500	Handheld MIG gun MASTER 150F set 5m	SPM15R-12-500	Handheld MIG gun MASTER 150R set 5m

CODE	DESCRIPTION
SPM25-12-300	Handheld MIG gun MASTER 250 set 3m
SPM25-12-400	Handheld MIG gun MASTER 250 set 4m
SPM25-12-500	Handheld MIG gun MASTER 250 set 5m

CODE	DESCRIPTION	CODE	DESCRIPTION
SPM25F-12-300	Handheld MIG gun MASTER 250F set 3m	SPM25R-12-300	Handheld MIG gun MASTER 250R set 3m
SPM25F-12-400	Handheld MIG gun MASTER 250F set 4m	SPM25R-12-400	Handheld MIG gun MASTER 250R set 4m
SPM25F-12-500	Handheld MIG gun MASTER 250F set 5m	SPM25R-12-500	Handheld MIG gun MASTER 250R set 5m

CODE	DESCRIPTION	CODE	DESCRIPTION
SPM24-12-300	Handheld MIG gun MASTER 240 set 3m	SPM24R-12-300	Handheld MIG gun MASTER 240R set 3m
SPM24-12-400	Handheld MIG gun MASTER 240 set 4m	SPM24R-12-400	Handheld MIG gun MASTER 240R set 4m
SPM24-12-500	Handheld MIG gun MASTER 240 set 5m	SPM24R-12-500	Handheld MIG gun MASTER 240R set 5m

CODE	DESCRIPTION	CODE	DESCRIPTION
SPM36-12-300	Handheld MIG gun MASTER 360 set 3m	SPM36R-12-300	Handheld MIG gun MASTER 360R set 3m
SPM36-12-400	Handheld MIG gun MASTER 360 set 4m	SPM36R-12-400	Handheld MIG gun MASTER 360R set 4m
SPM36-12-500	Handheld MIG gun MASTER 360 set 5m	SPM36R-12-500	Handheld MIG gun MASTER 360R set 5m

150 250 240/241 360 401/501

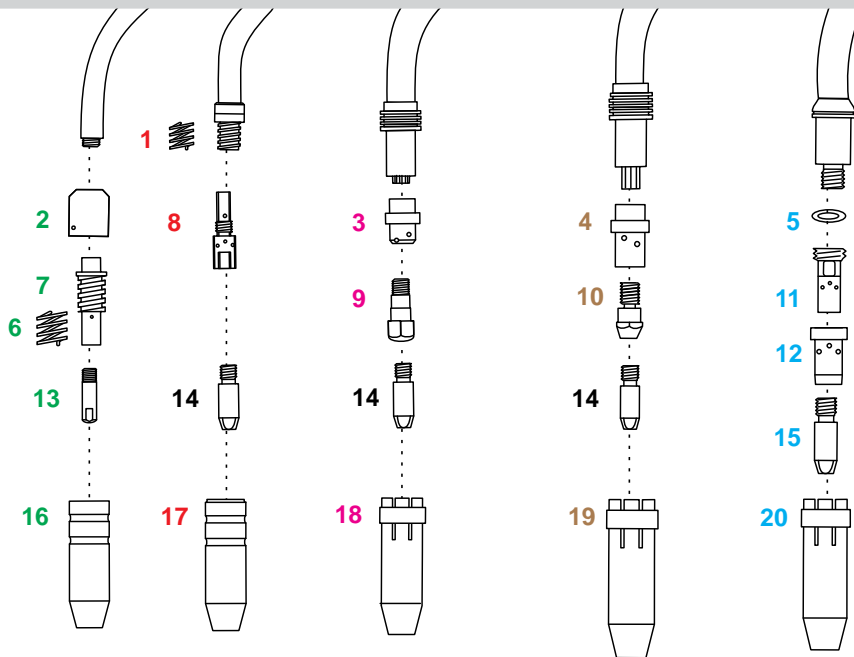

NO.	DESCRIPTION	CODE
1	Spring	25-31-006
2	Insulator ring	15-32-006
3	Ceramic gas diffuser	24-40-001
	White gas diffuser	24-41-001
	Black gas diffuser	24-42-001
	Silicone, red diffuser	24-44-001
4	Ceramic gas diffuser	36-40-001
	White gas diffuser	36-41-001
	Black gas diffuser	36-42-001
5	Insulator ring	51-31-001
6	Spring	15-31-006
7	Contact tip holder with spring	15-30-006
8	Contact tip holder M6	25-30-006
	Contact tip holder M8*	25-30-008
9	Contact tip holder M6	24-30-006
10	Contact tip holder M6	36-30-006
	Contact tip holder M8*	36-30-008
11	Contact tip holder M6**	51-30-006
	Contact tip holder M8	51-30-008
12	Ceramic gas diffuser	51-40-001
	White gas diffuser	51-41-001
	Black gas diffuser	51-42-001

* use with contact tips M8x30mm
 ** use with contact tips M6x28mm

NO.	CONTACT TIPS	WIRE DIAMETER [mm] / CODE								
		0,6	0,8	1,0	1,2	1,4	1,6	2,4	2,4	3,0
13	E-Cu	15-20-006	15-20-008	15-20-010	15-20-012	15-20-014	15-20-016	-	-	-
	E-Cu economic	-	15-20-008E	15-20-010E	15-20-012E	-	-	-	-	-
	E-Cu for Al	-	15-21-008	15-21-010	15-21-012	-	-	-	-	-
	CuCrZr	-	15-22-008	15-22-010	15-22-012	15-22-014	-	-	-	-
14	E-Cu	25-20-006	25-20-008	25-20-010	25-20-012	25-20-014	25-20-016	-	-	-
	E-Cu economic	-	25-20-008E	25-20-010E	25-20-012E	-	-	-	-	-
	E-Cu for Al	-	25-21-008	25-21-010	25-21-012	-	-	-	-	-
	CuCrZr	-	25-22-008	25-22-010	25-22-012	-	-	-	-	-
15	E-Cu	-	51-20-008	51-20-010	51-20-012	51-20-014	51-20-016	51-20-020	51-20-024	51-20-030
	E-Cu economic	-	51-20-008E	51-20-010E	51-20-012E	51-20-014E	51-20-016E	-	-	-
	E-Cu for Al	-	51-21-008	51-21-010	51-21-012	-	51-21-016	-	-	-
	CuCrZr	-	51-22-008	51-22-010	51-22-012	51-22-014	51-22-016	51-22-020	-	51-22-030

NO.	DESCRIPTION	DESCRIPTION / CODE		
		tight conical	conical	cylindrical
16	Gas nozzle	15-50-095	15-50-120	15-50-160
17	Gas nozzle	25-50-115	25-50-150	25-50-180
18	Gas nozzle	24-50-100	24-50-125	24-50-170
19	Gas nozzle	36-50-120	36-50-160	36-50-190
20	Gas nozzle	51-50-140	51-50-160	51-50-200

INSULATED STEEL LINER

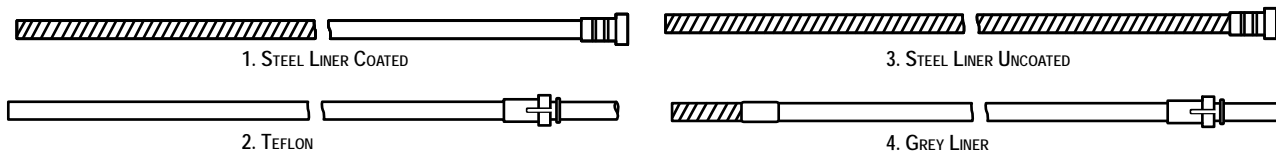

NO.	DESCRIPTION	CODE					
		Length [m]	3,4	4,4	5,4	mb.	Steel liner back end
1	Blue recommended for wire 0,6-0,8mm		15-58-008	15-59-008	15-60-008	15-61-008	15-62-012
	Red recommended for wire 1,0-1,2mm		15-58-012	15-59-012	15-60-012	15-61-012	15-62-012
	Yellow recommended for wire 1,6mm		15-58-016	15-59-016	15-60-016	15-61-016	15-62-016
2	Blue recommended for wire 0,6-0,8mm		25-58-008	25-59-008	25-60-008	25-61-008	25-62-012
	Red recommended for wire 1,0-1,2mm		25-58-012	25-59-012	25-60-012	25-61-012	25-62-012
	Yellow recommended for wire 1,6mm		25-58-016	25-59-016	25-60-016	25-61-016	25-62-016
3	Recommended for wire 1,0mm-1,2mm		51-58-012	51-59-012	51-60-012	51-61-012	51-62-012
	Recommended for wire 1,6mm		51-58-016	51-59-016	51-60-016	51-61-016	51-62-016

NO.	DESCRIPTION	CODE			
		Length [m]	3,5	4,5	5,5
4	Recommended for wire 1,0mm-1,2mm		26-58-012	26-59-012	26-60-012
	Recommended for wire 1,6mm		26-58-016	26-59-016	26-60-016